

FINE series PURE Standard series



FUCI-715-6.35



FUD-95-6.35



FUBV-915-6.35

Excellent, Ultimate, Fine, Clean & Safe Technology



We have taken in the proposal from customer into all products.

Excellent, Ultimate, Fine, Clean & Safe Technology

STOP VALVE

NEEDLE VALVE

UPPER MINI BALL VALVE

LINE CHECK VALVE

FILTER

STOP VALVE

NEEDLE VALVE

UPPER MINI BALL VALVE

LINE CHECK VALVE

FILTER

Fujikin's Class 1 cleanrooms feature cutting-edge technology throughout, and must exceed the most rigorous standards for cleanliness. Products manufactured in this environment are therefore guaranteed to meet the most stringent requirements and to be of the highest quality worldwide.

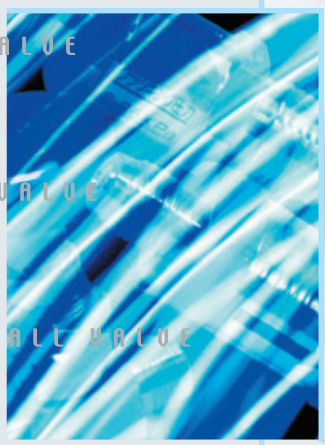



INDEX

STANDARD series

Stop • Needle Valves

Stop Valves	3
Needle Valves	4

Super Mini Ball Valves

Super Mini Ball Valves	7
3-way Super Mini Ball Valves	8

Line Check Valves

Line Check Valves	11
-------------------------	----

Filters

Filters	13
---------------	----

STOP VALVES

Stainless Steel 4.9 MPa (On / Off Valves)

FUD-95 type

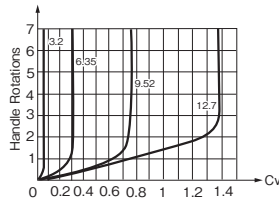

FUD-05 type

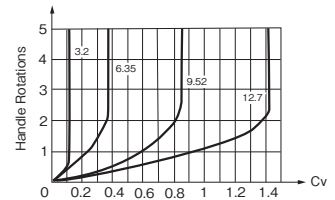

FUD-15 type

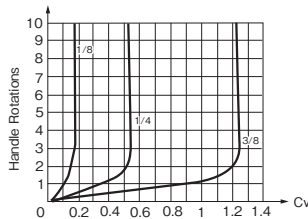
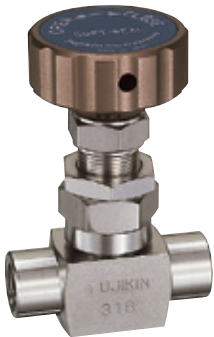

FUD-35 type

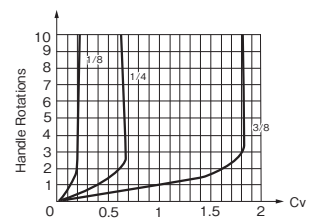

FEATURES / SPECIFICATIONS

- All wetted surfaces are completely oil-free
- Compact size and lightweight
- Outside thread type with packing mechanism

Materials	Parts	Materials
	Body	SUS316L
	Bonnet	SUS316
	Stem	SUS316
	Disk Packing	PCTFE
	Gland Packing	PTFE·PFA
	Handle	A5056

Temperature · Pressure Rating

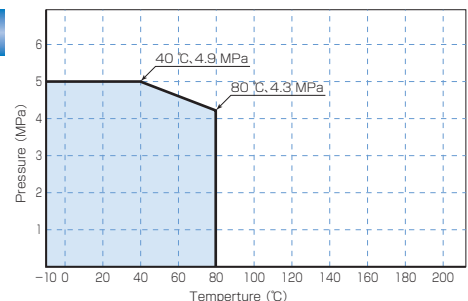

NEEDLE VALVES

Stainless Steel 4.9 MPa (Flow Control Valves)

FUN-95 type
FUE-95 type
FUH-95 type

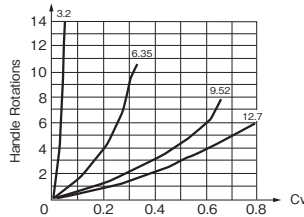

FUN-05 type
FUE-05 type
FUH-05 type

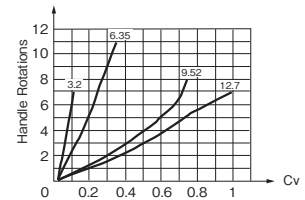

FUN-15 type
FUE-15 type
FUH-15 type

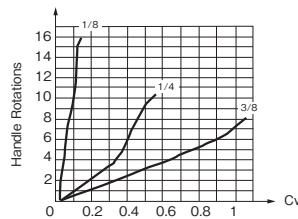
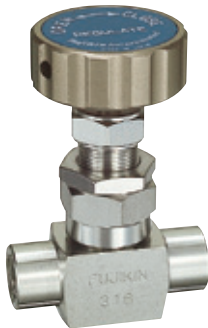

FUN-35 type
FUE-35 type
FUH-35 type

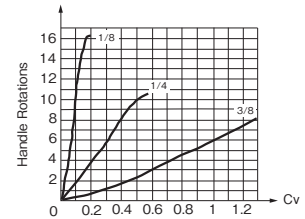

FEATURES / SPECIFICATIONS

- All wetted surfaces are completely oil-free
- Compact size and lightweight
- Highly-precise flow control
- Outside thread type with packing mechanism

Materials	Parts	Materials
	Body	SUS316L
	Bonnet	SUS316
	Stem	SUS316
	Gland Packing	PTFE·PFA
	Handle	A5056

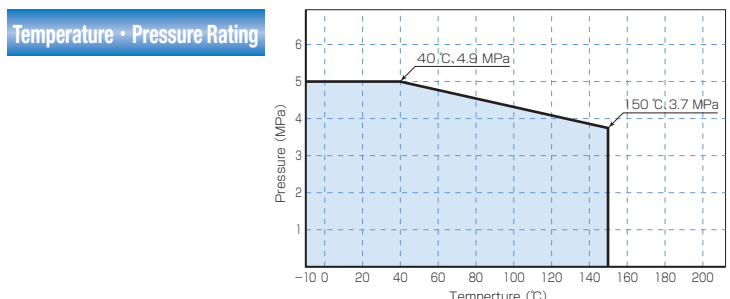

SPECIFICATIONS

Stop Valves

Specifications	Nominal Diameter	Maximum Operating Pressure	Fluid Temperature Range	Orifice Diameter(mm)	Max.Cv Value	Valve Type	End Connection
	3.2	4.9 MPa 710 psi	-10~+80 °C 14~176 °F	2.5	0.05	Globe Angle	F900 Fitting Threaded Fitting
	1/8"			2.5	0.16		
	6.35			5	0.3		
	1/4"			5	0.5		
	9.52			8	1		
	3/8"			8	1.2		
	12.7			8	1.37		

Needle Valves

Specifications	Nominal Diameter	Maximum Operating Pressure	Fluid Temperature Range	Orifice Diameter(mm)	Max.Cv Value	Valve Type	End Connection
	3.2	4.9 MPa 710 psi	-10~+150 °C 14~302 °F	2.5	0.045	Globe Angle	F900 Fitting Threaded Fitting
	1/8"			2.5	0.125		
	6.35			5	0.3		
	1/4"			5	0.45		
	9.52			8	0.62		
	3/8"			8	1		
	12.7			8	0.78		

OPTIONS

NPT Thread Rc thread is standard for threaded type end connection; NPT may be available.

ORDERING NUMBER DESIGNATION

Please use the ordering number designations below when placing order.

FU E - 9 5 - 6.35

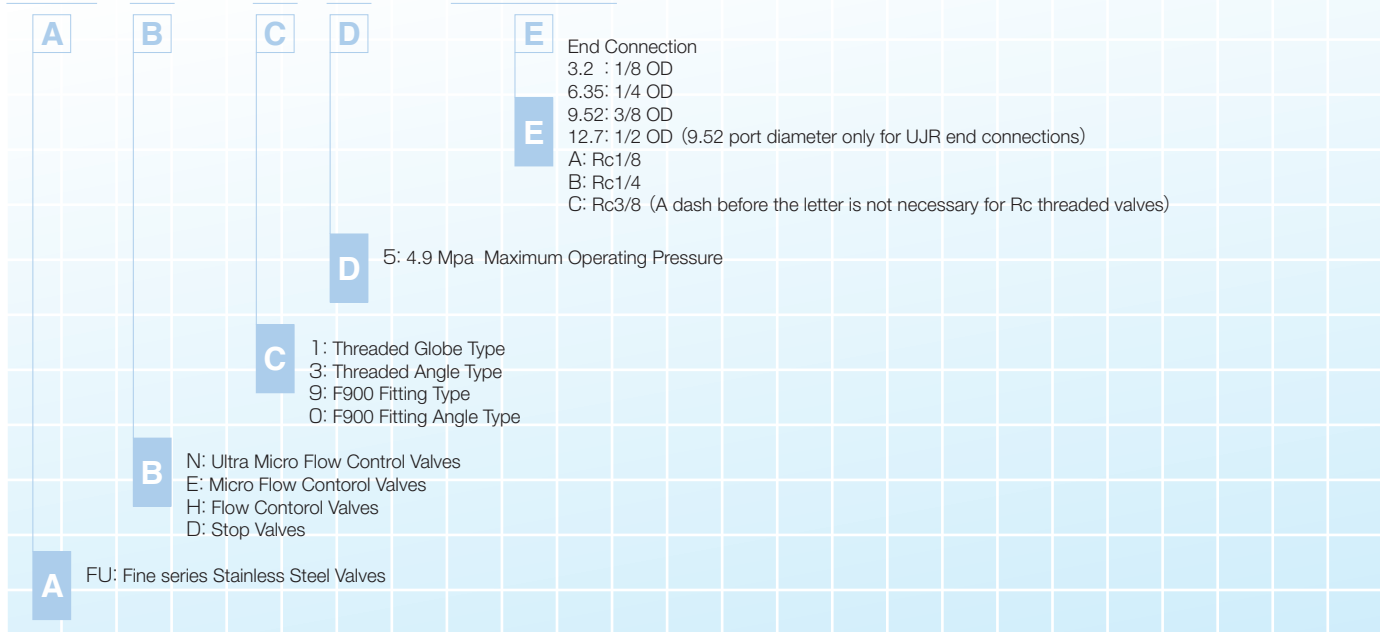

Actual shipped products may have additional designations (such as #A, #B) in the ordering number. These indicate production history and do not indicate a change in function or dimensions.

DIMENSIONS

Individual drawings can be downloaded from the CAD Data Service section of the Fujikin website. https://www.fujikin.co.jp/cad_se/

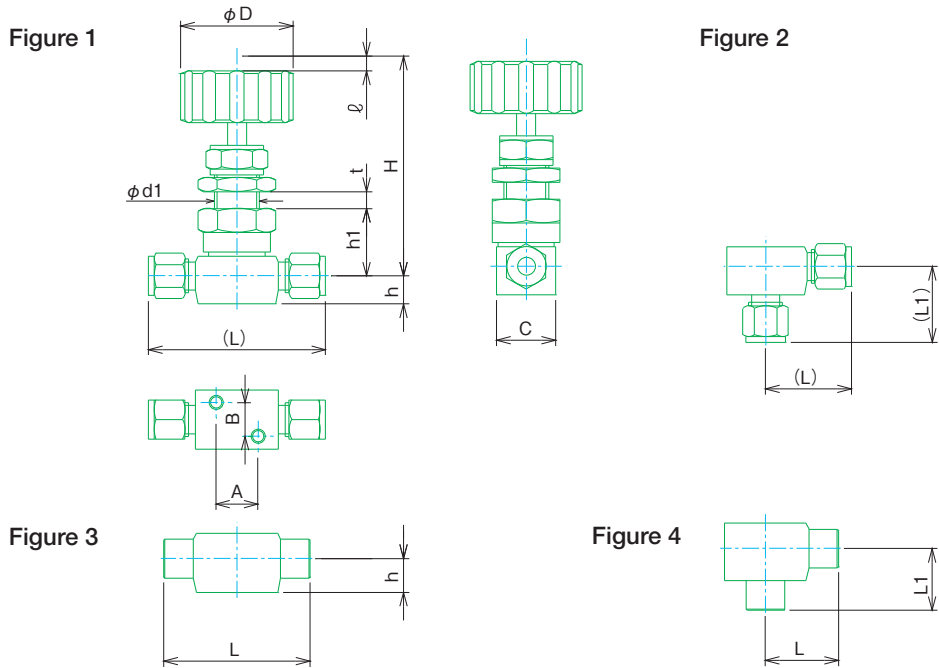

(unit: mm)

Nom. Diameter	Ordering Numbers	Figure	End-to-End		Height H	Panel mt ht h1	phi d1	t	h	Stroke l	Handle phi D	A	B	C
			L	L1										
3.2	FUN-95-3.2 FUD-95-3.2	1	57	-	69	24	14.5	6	10	7	32	15	12	21
6.35	FUE-95-6.35 FUD-95-6.35	1	63	-	73	24	16.5	6	9.5	7	40	15	12	21
9.52	FUH-95-9.52 FUD-95-9.52	1	71	-	81	26	20.5	6	11.5	7	50	20	15	26
12.7	FUH-95-12.7 FUD-95-12.7	1	81	-	82	27	20.5	6	14	7	50	20	15	26
3.2	FUN-05-3.2 FUD-05-3.2	2	28.5	23	69	24	14.5	6	-	7	32	-	-	21
6.35	FUE-05-6.35 FUD-05-6.35	2	30.5	27	73	24	16.5	6	-	7	40	-	-	21
9.52	FUH-05-9.52 FUD-05-9.52	2	33.5	30	81	26	20.5	6	-	7	50	-	-	26
12.7	FUH-05-12.7 FUD-05-12.7	2	40.5	35	82	27	20.5	6	-	7	50	-	-	26
1/8"	FUN-15A FUD-15A	3	46	-	71	24	14.5	6	10	7	32	15	12	21
1/4"	FUE-15B FUD-15B	3	52	-	75	26	16.5	6	12	7	40	15	12	21
3/8"	FUH-15C FUD-15C	3	58	-	83	28	20.5	6	13	7	50	20	15	26
1/8"	FUN-35A FUD-35A	4	23	19	71	24	14.5	6	-	7	32	-	-	21
1/4"	FUE-35B FUD-35B	4	26	22	75	26	16.5	6	-	7	40	-	-	21
3/8"	FUH-35C FUD-35C	4	29	25	83	28	20.5	6	-	7	50	-	-	26

Please see Figure 1 for dimension keys not shown in other Figures.

Please download the latest catalogue: <http://www.fujikin.co.jp/go/c11300e>

SUPER MINI BALL VALVES

Stainless Steel 16.2 MPa

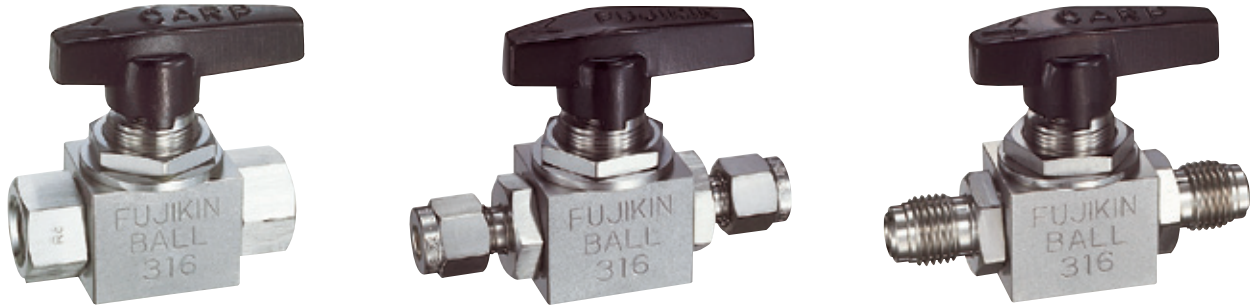

FEATURES

- All wetted surfaces are completely oil-free
- Available with ultra-pure treatment
- Compact size and lightweight
- Panel mount hardware is standard

SPECIFICATIONS

Materials	Parts	Materials
	Body	SUS316
	Ball	SUS316
	Seat Packing	Special Packing
	Gland Packing	PTFE
	Handle	ZDC2

Temperature · Pressure Rating

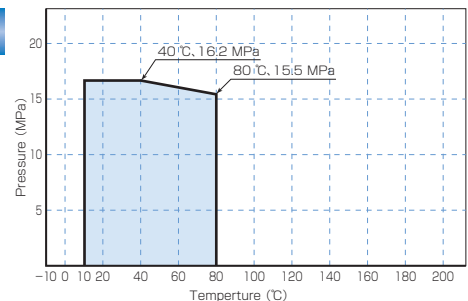

3-WAY SUPER MINI BALL VALVES

Stainless Steel 16.2 MPa

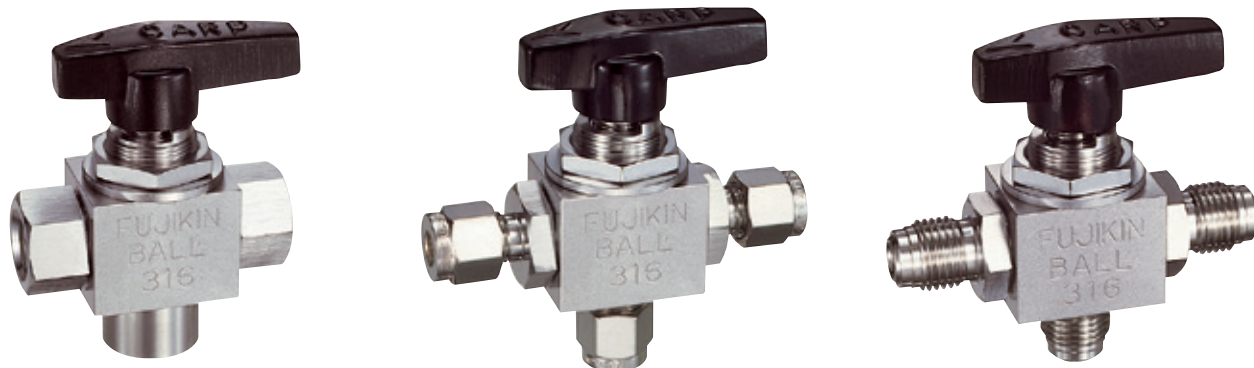

FEATURES

- All wetted surfaces are completely oil-free
- Available with ultra-pure treatment
- Compact size and lightweight
- Panel mount hardware is standard

Attention

3-Way valves must be installed in the configuration as shown below. Flow in any other direction as shown may not allow the seats to seal sufficiently.

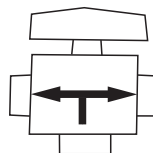

Proper flow direction should be in from the bottom port and out through the left and right ports.

SPECIFICATIONS

Materials	Parts	Materials
	Body	SUS316
	Ball	SUS316
	Seat Packing	Special Packing
	Gland Packing	PTFE
	Handle	ZDC2

Temperature • Pressure Rating

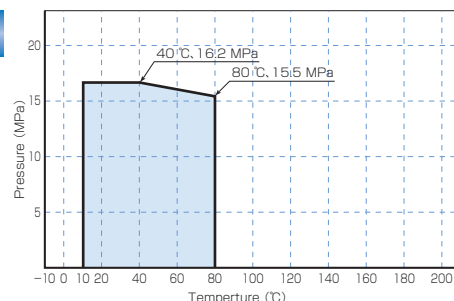

SPECIFICATIONS

Specifications	Nominal Diameter	Maximum Operating Pressure	Fluid Temperature Range	Maximum Cv	End Connection
	3.2	16.2 MPa 2350 psi	-10~+80 °C 14~176 °F	0.23	F900 Fitting UJR Fitting Threaded Fittig
	6.35 (1/4")			2-port valve: 0.6 3-port valve: 0.5	
	9.52 (3/8")			2-port valve: 2 3-port valve: 2	
	12.7 (1/2")			2-port valve: 4 3-port valve: 4	

Attention When the temperature rises in the state that body cavity (pocket) is filled with fluid inside, the pressure rises abnormally in the body cavity (pocket), and the seat will be damaged. Please consult **Fujikin** for such a phenomenon.

OPTIONS

NPT Thread Rc thread is standard for threaded type end connection; NPT may be optionally specified.

ORDERING NUMBER DESIGNATION

Please use the ordering number designations below when placing order.

FUBV T - 9 15 - 6.35

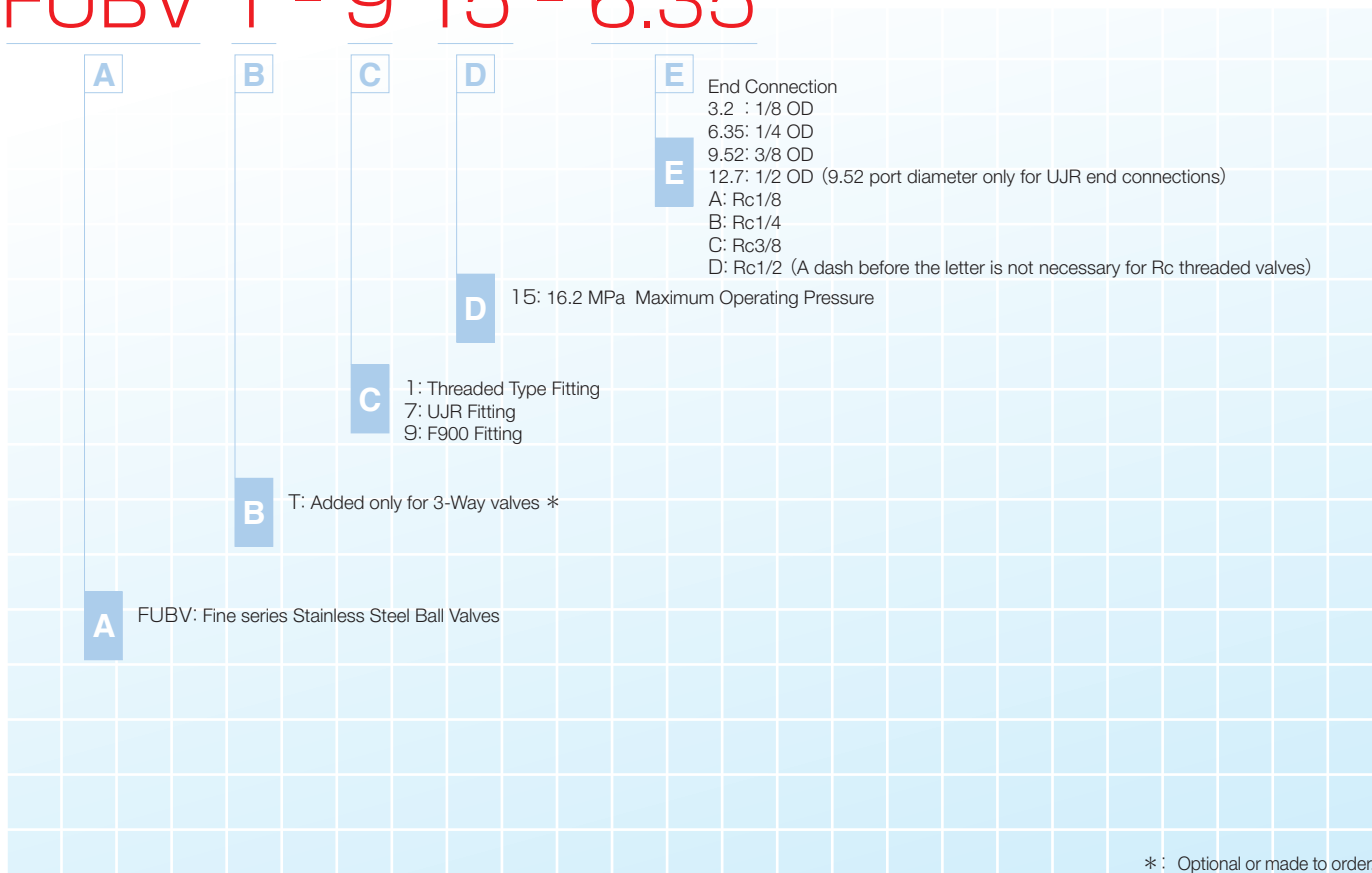

*: Optional or made to order.

Actual shipped products may have additional designations (such as #A, #B) in the ordering number. These indicate production history and do not indicate a change in function or dimensions.

DIMENSIONS

Individual drawings can be downloaded from the CAD Data Service section of the Fujikin website. https://www.fujikin.co.jp/cad_se/

Figure 1

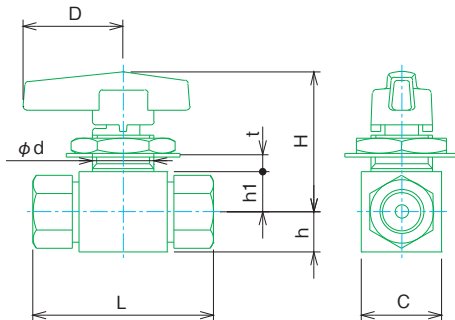

Figure 2

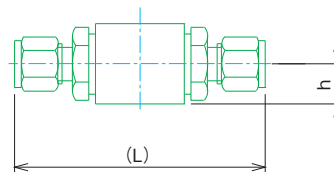

Figure 3

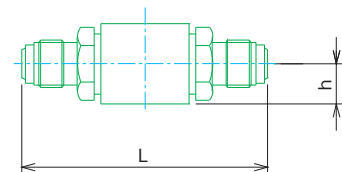

Figure 4

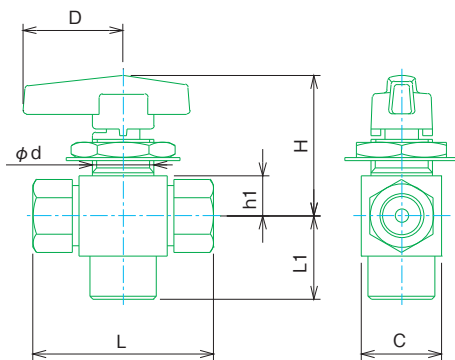

Figure 5

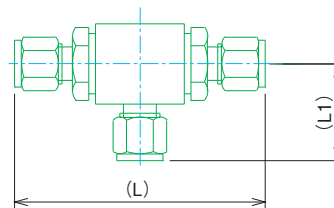
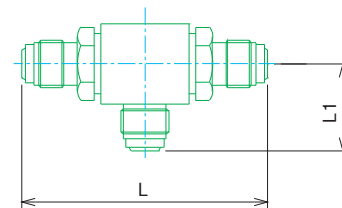

Figure 6



Super Mini Ball Valves

(unit: mm)

Nom. Diameter	Ordering Numbers	Figure	End to End		Height		Panel mt ht		Handle D	C
			L	H	h1	d2	h			
1/4"	FUBV-115B	1	54	42	12	18.5	12	30	24	
3/8"	FUBV-115C	1	55	52	16	27.5	16	35	28	
1/2"	FUBV-115D	1	75	56	20	36.5	20	55	40	
3.2	FUBV-915-3.2	2	70	39	10	14.5	10	25	21	
6.35	FUBV-915-6.35	2	75	42	12	18.5	12	30	24	
9.52	FUBV-915-9.52	2	88	52	16	27.5	16	35	28	
12.7	FUBV-915-12.7	2	121	56	20	36.5	20	55	40	
6.35	FUBV-715-6.35	3	73.6	42	12	18.5	12	30	24	
9.52	FUBV-715-9.52	3	86.6	52	16	27.5	16	35	28	

3-Way Super Mini Ball Valves

(unit: mm)

Nom. Diameter	Ordering Numbers	Figure	End to End		Height		Panel mt ht		Handle D	C
			L	H	L1	h1	d2			
1/4"	FUBVT-115B	4	54	42	25	12	18.5	30	24	
3/8"	FUBVT-115C	4	55	52	30	16	27.5	35	28	
1/2"	FUBVT-115D	4	75	56	37.5	20	36.5	55	40	
3.2	FUBVT-915-3.2	5	70	39	25	10	14.5	25	21	
6.35	FUBVT-915-6.35	5	75	42	29	12	18.5	30	24	
9.52	FUBVT-915-9.52	5	88	52	35	16	27.5	35	28	
12.7	FUBVT-915-12.7	5	121	56	43	20	36.5	55	40	
6.35	FUBVT-715-6.35	6	73.6	42	26	12	18.5	30	24	
9.52	FUBVT-715-9.52	6	86.6	52	31.5	16	27.5	35	28	

LINE CHECK VALVES

Stainless Steel 16.2 MPa



FEATURES

- All wetted surfaces are completely oil-free
- Superior cracking performance
- Compact size and lightweight

INSTALLATION CONSIDERATIONS

1. In an installation where there is minimal differential pressure - such as in a vacuum line - sealing performance seldom varies.
2. For best Check Valve sealing efficiency and performance, back-pressure is required, (which will increase cracking pressure).
3. During initial operation, or after Check Valve has been closed for an extended time, cracking pressure may be higher than value indicated on body.
4. Cracking pressure indicated on valve body is for constant flow; valve will actually open at a lower pressure than indicated.

SPECIFICATIONS - MATERIALS

Specifications	Nominal Diameter	Maximum Operating Pressure	Fluid Temperature Range	Orifice Diameter(mm)	Max.Cv	Cracking Pressure	Back Pressure	End Connection
	3.2	16.2 MPa 2,350 psi	-10~+80 °C 14~176 °F	2.7	0.16	2.26 KPa 0.33 psi	0.0294 MPa or more 4.25 psi or more	F900 Fitting UJR Fitting Threaded Fitting
	6.35 (1/4")			4	0.35	6.86 KPa 1 psi	0.0294 MPa or more 4.26 psi or more	
	9.52 (3/8")			7.5	1.1	68.6 KPa 10 psi	0.0049 MPa or more 0.71 psi or more	
	12.7 (1/2")			7.5	1.1	172 KPa 25 psi	0.0049 MPa or more 0.71 psi or more	

Materials	Parts	Materials
	Body	SUS316
	Disk	SUS316
	Seat Packing	FKM
	Spring	SUS316WPA
	Gasket	SUS316

OPTIONS

- Seat Packing material may be specified according to the kind of gas.

Optional Seat Packing Materials Available
Chloroprene rubber, silicon rubber, ethylene-propylene rubber, Kalrez®, teflon®

- Surface Treatment: UP Treatment can be applied
- NPT Thread: Rc thread is standard: NPT thread may be made to order.

DIMENSIONS

Individual drawings can be downloaded from the CAD Data Service section of the Fujikin website. https://www.fujikin.co.jp/cad_se/

Figure 1

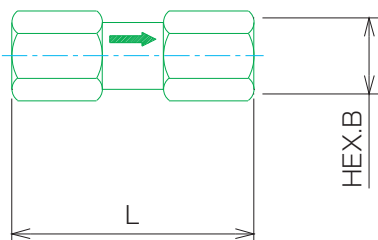

Figure 2

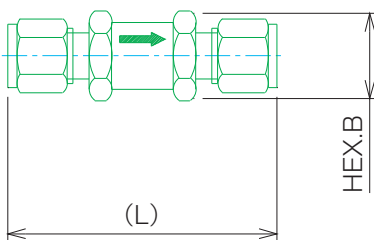
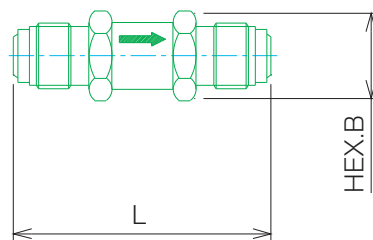

Figure 3



(unit: mm)				
Nominal Diameter	Ordering Numbers	Figure	L	HEX.B
1/8"	FUCL-115A	1	43	17
1/4"	FUCL-115B	1	53	17
3/8"	FUCL-115C	1	60	23
1/2"	FUCL-115D	1	69	26
3.2	FUCL-915-3.2	2	55	17
6.35	FUCL-915-6.35	2	59	17
9.52	FUCL-915-9.52	2	70.5	23
12.7	FUCL-915-12.7	2	78.5	23
6.35	FUCL-715-6.35	3	56.4	17
9.52	FUCL-715-9.52	3	69.1	23

ORDERING NUMBER DESIGNATION

Please use the ordering number designations below when placing order.

FUCL - 9 15 - 6.35 - 0.07 - [] - []

A

FUCL: Stainless Steel Line Check Valves

B

1: Threaded Type Fitting
7: UJR Fitting
9: F900 Fitting Type

C

15: 16.2 MPa Maximum Operating Pressure

D

End Connection
3.2 : 1/8 OD
6.35: 1/4 OD
9.52: 3/8 OD
12.7: 1/2 OD (9.52 port diameter only for UJR end connections)
A: Rc1/8
B: Rc1/4
C: Rc3/8
D: Rc1/2 (A dash before the letter is not necessary for Rc threaded valves)

E

Cracking Pressure
0.023: 2.26 KPa
0.07 : 6.86 KPa
0.7 : 68.6 KPa
1.75 : 172 KPa

F

CR: Chloroprene Rubber *
S I: Silicon Rubber *
ER: Ethylene-propylene Rubber *
KA: Kalrez® *
TF: Teflon® *

G

UP: UP Treatment *

* : Optional or made to order.

Actual shipped products may have additional designations (such as #A, #B) in the ordering number. These indicate production history and do not indicate a change in function or dimensions.

Please download the latest catalogue: <http://www.fujikin.co.jp/go/c11300e>

FILTERS

Stainless Steel 16.2 MPa



FEATURES

- All wetted surfaces are completely oil-free
- Compact size and lightweight

SPECIFICATIONS - MATERIALS

Materials	Parts	Materials
	Body	SUS316
	Filter Element	SUS316
	Gasket	SUS316+Ag coating PTFE

Specifications	Nominal Diameter	Maximum Operating Pressure	Fluid Temperature Range	Filter Shape	End Connection
	1/8B 6.35 (1/4B)	16.2 MPa 2,350 psi	-10~+100 °C 14~212 °F	line Type Tee Type	F900 Fitting UJR Fitting (line-type only) Threaded Fitting
	9.52 (3/8B)				
	12.7 (1/2B)				

OPTIONS

- NPT Thread: Rc thread is standard; NPT thread may be made to order.
- Many line filter element sizes are available; please select the proper one for your use from the charts below.

Line Filter Element Sizes

Nominal Diameter	Element Size (µm)						
	0.1	0.5	2	5	10	40	70
1/8"	△	△	△	△	△	△	△
6.35, 1/4"	○ *1	○ *1	○	○	○	△	△
9.52, 3/8"	○ *2	○ *2	○	○	○	△	△
12.7, 1/2"	△	△	○	○	○	△	△

Tee Filter Element Sizes

Nominal Diameter	Element Size (µm)						
	0.1	0.5	2	5	10	40	70
1/8"	△	△	△	△	△	△	△
6.35, 1/4"	○ *2	○ *2	○	○	○	△	△
9.52, 3/8"	△	△	○	○	○	△	△
12.7, 1/2"	△	△	○ *2	○ *2	○ *2	△	△

△: Made to order product *1: Only Finelok (F900) and UJR types are standard. *2: Only Finelok is standard.

DIMENSIONS

Individual drawings can be downloaded from the CAD Data Service section of the Fujikin website. https://www.fujikin.co.jp/cad_se/

Figure 1

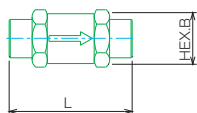

Figure 2

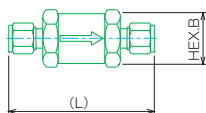

Figure 3

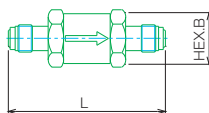

Figure 4

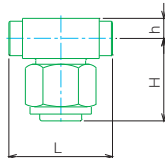
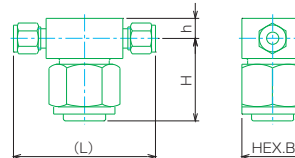

Figure 5



Line Filter Dimensions

(unit: mm)

Nominal Diameter	Ordering Numbers	Figure	L	B
1/8"	FUFL-115A	1	64	26
1/4"	FUFL-115B	1	64	26
3/8"	FUFL-115C	1	78	32
1/2"	FUFL-115D	1	84	32
6.35	FUFL-915-6.35	2	76	26
9.52	FUFL-915-9.52	2	86	32
12.7	FUFL-915-12.7	2	94	32
6.35	FUFL-715-6.35	3	81.8	26
9.52	FUFL-715-9.52	3	84.6	32

Tee Filter Dimensions

(unit: mm)

Nominal Diameter	Ordering Numbers	Figure	L	H	h	B
1/8"	FUFT-115A	4	54	43	10.5	32
1/4"	FUFT-115B	4	54	43	10.5	32
3/8"	FUFT-115C	4	70	52	16	36
1/2"	FUFT-115D	4	70	52	16	36
6.35	FUFT-915-6.35	5	74	43	10.5	32
9.52	FUFT-915-9.52	5	90	50	14	36
12.7	FUFT-915-12.7	5	96	50	14	36

ORDERING NUMBER DESIGNATION

Please use the ordering number designations below when placing order.

FUF L - 9 15 - 6.35 - 2

A

B

C

D

E

F

A

FUF: Stainless Steel Filters

B

L: Line Type
T: Tee Type

C

1: Threaded Type Fitting
7: UJR Fitting
9: F900 Fitting Type

D

15: 16.2 MPa Maximum Operating Pressure

E

End Connection
6.35: 1/4 OD
9.52: 3/8 OD
12.7: 1/2 OD (9.52 port diameter only for UJR end connections)
A: Rc1/8
B: Rc1/4
C: Rc3/8
D: Rc1/2 (A dash before the letter is not necessary for Rc threaded valves)

F

Element Size
2 : 2 μm Element Size
5 : 5 μm Element Size
10 : 10 μm Element Size
40 : 40 μm Element Size *
70 : 70 μm Element Size *

* : Optional or made to order.

Actual shipped products may have additional designations (such as #A, #B) in the ordering number. These indicate production history and do not indicate a change in function or dimensions.

Please download the latest catalogue: <http://www.fujikin.co.jp/go/c11300e>



Fujikin Carp Group



The Year 2013 Prime Minister's Prize
The 5th Monodzukuri Nippon Grand Award
Overseas Operation "Excellence Prize"

URL <http://www.fujikin.co.jp/> E-mail info@fujikin.co.jp

CAT: No.701-01E-C